

No.	DESCRIPTION	DWG No	HAPE CODE	ENERGY RECOVERY						REMARKS
				Qty.	Qty.	Qty.	Qty.	Qty.	Qty.	
				KPI-252E4E 1-230V 50Hz	KPI-502E4E 1-230V 50Hz	KPI-802E4E 1-230V 50Hz	KPI-1002E4E 1-230V 50Hz	KPI-1502E4E 1-230V 50Hz	KPI-2002E4E 1-230V 50Hz	
				70603000	70603001	70603002	70603003	70603004	70603005	
				PRODUCT CODE						
				MODEL NAME						
1	Duct Connector	-	E03190	4						Plastic material
1	Duct Connector	-	E01725		4					Plastic material
1	Duct Connector	-	E01726			4				Plastic material
1	Duct Connector	-	E01728				4			Plastic material
1	Duct Connector	-	E01729					4	4	Plastic material
2	Duct Connection Sealing Strip	-	E03191	4						For Duct Connector
2	Duct Connection Sealing Strip	-	E01730		4					For Duct Connector
2	Duct Connection Sealing Strip	-	E01731			4				For Duct Connector
2	Duct Connection Sealing Strip	-	E01733				4			For Duct Connector
2	Duct Connection Sealing Strip	-	E01734					4	4	For Duct Connector
3	Damper Motor	-	E01736	1	1	1	1	1	1	AC Motor for Damper
4	Exchanger Guide Gasket	-	E01737	4	4	4	4	4	4	
5	Fan Assy	-	E03192	2						Fan Cover
5	Fan Assy	-	E03193		2					Fan Cover
5	Fan Assy	-	E03194			2				Fan Cover
5	Fan Assy	-	E03195				2			Fan Cover
5	Fan Assy	-	E03196					2	2	Fan Cover
6	Air Filter	-	E04168	2						Inlet & Outlet Air
6	Air Filter	-	E04169		2					Inlet & Outlet Air
6	Air Filter	-	E04170			2				Inlet & Outlet Air
6	Air Filter	-	E04171				2			Inlet & Outlet Air
6	Air Filter	-	E04172					2		Inlet & Outlet Air
6	Air Filter	-	E04173						2	Inlet & Outlet Air
7	Heat Exchanger	-	E04746	2						Celluloid Heat Exchanger
7	Heat Exchanger	-	E04747		1					Celluloid Heat Exchanger
7	Heat Exchanger	-	E04748		1					Celluloid Heat Exchanger
7	Heat Exchanger	-	E04749			1	2			Celluloid Heat Exchanger
7	Heat Exchanger	-	E04750			1				Celluloid Heat Exchanger
7	Heat Exchanger	-	E04751					1	2	Celluloid Heat Exchanger
7	Heat Exchanger	-	E04752					1		Celluloid Heat Exchanger
8	Fan Service Cover	-	E03199	2	2	2	2	2	2	
9	Heat Exchanger Cover Clamp	-	E01782	2	2	2	2	2	2	
10	E-Box Cover	-	E03202	1						
10	E-Box Cover	-	E03203		1	1	1	1	1	
11	Fuse	XEK35307 A	E01757	2	2	2				2 A (6x32) - Fan Protection
11	Fuse	XEK35307 B	E01758				2	2	2	4 A (6x32) - Fan Protection
12	Transformer	XEK22108 A	E01295	1	1	1	1	1	1	Main Transformer
13	Printed Circuit Board (PI073)	XEK37138 F	E04324	1	1	1	1	1	1	
14	Printed Circuit Board	XEK37023 D	E04706	1	1	1	1	1	1	
15	Terminal Board	XEK21159 A	E00750	1	1	1	1	1	1	
16	Fuse Holder	17C68766 A	E02516	2	2	2	2	2	2	
17	Thermistor	17B24598 B	P25234	1	1	1	1	1	1	Blue Socket
18	Thermistor	17B24598 G	P22436	1	1	1	1	1	1	Red Socket
19	Spacer	XEK30992 B	P19112	8	8	8	8	8	8	Main PCB Holder
20	Push Spacer	XEK31888 A	E00738	4	4	4	4	4	4	
21	Electrical Box	XEK01211 A	E03200	1						Assembly (Components+Harness)
21	Electrical Box	XEK01211 B	E03201		1	1	1	1	1	Assembly (Components+Harness)
27	Remote Control	70510002	E04714	1	1	1	1	1	1	PC-ARFPE (Optional)
28	PCB Assy	-	E04323	1	1	1	1	1	1	
29	HEX Service Cover	-	E04031	1						
29	HEX Service Cover	-	E04032		1					
29	HEX Service Cover	-	E04033			1	1			
29	HEX Service Cover	-	E04034					1	1	

No.	DESCRIPTION	DWG No	HAPE CODE	ACTIVE			REMARKS
				PRODUCT CODE	MODEL NAME	Qty.	
				70603201	KPI-502X4E 1~ 230V 50Hz		
				70603202	KPI-802X4E 1~ 230V 50Hz		
				70603203	KPI-1002X4E 1~ 230V 50Hz		
No.	DESCRIPTION	DWG No	HAPE CODE	Qty.	Qty.	Qty.	REMARKS
1	Duct Connector	-	E01725	4			Plastic material
1	Duct Connector	-	E01726		4		Plastic material
1	Duct Connector	-	E01728			4	Plastic material
2	Duct Connection Sealing Strip	-	E01730	4			For Duct Connector
2	Duct Connection Sealing Strip	-	E01731		4		For Duct Connector
2	Duct Connection Sealing Strip	-	E01733			4	For Duct Connector
3	Damper Motor	-	E01736	1	1	1	AC Motor for Damper
4	Exchanger Guide Gasket	-	E01737	4	4	4	
5	Fan Assy	-	E03193	2			Fan Cover
5	Fan Assy	-	E03194		2		Fan Cover
5	Fan Assy	-	E03195			2	Fan Cover
6	Air Filter	-	E04169	2			Inlet & Outlet Air
6	Air Filter	-	E04170		2		Inlet & Outlet Air
6	Air Filter	-	E04171			2	Inlet & Outlet Air
7	Heat Exchanger	-	E04746	1			Celluloid Heat Exchanger
7	Heat Exchanger	-	E04747	1			Celluloid Heat Exchanger
7	Heat Exchanger	-	E04748		1	2	Celluloid Heat Exchanger
7	Heat Exchanger	-	E04749		1		Celluloid Heat Exchanger
8	Fan Service Cover	-	E03199	2	2	2	
9	Heat Exchanger Cover Clamp	-	E01782	2	2	2	
10	E-Box Cover	-	E03203	1	1	1	
11	Fuse	XEK35307 A	E01757	2	2		2 A (6x32) - Fan Protection
11	Fuse	XEK35307 B	E01758			2	4 A (6x32) - Fan Protection
12	Transformer	XEK22108 A	E01295	1	1	1	Main Transformer
13	Printed Circuit Board (PI073)	XEK37138 F	E04324	1	1	1	
14	Printed Circuit Board	XEK37023 D	E04706	1	1	1	
15	Terminal Board	XEK21159 A	E00750	1	1	1	
16	Fuse Holder	17C68766 A	E02516	2	2	2	
17	Thermistor	17B24598 B	P25234	2	2	2	Blue Socket
18	Thermistor	17B24598 G	P22436	2	2	2	Red Socket
19	Spacer	XEK30992 B	P19112	8	8	8	Main PCB Holder
20	Push Spacer	XEK31888 A	E00738	4	4	4	
21	Electrical Box	XEK01211 B	E03201	1	1	1	
22	Dx-coil service cover	-	E03204	1	1	1	
23	Float switch	17B24618 C	E00726	1	1	1	
24	Thermistor	17C74419 J	E01198	1	1	1	Blue Socket (Freeze)
25	Thermistor	17B41046 E	E02443	1	1	1	Yellow Socket (Gas)
26	Dx-Coil Module	-	E03212	1			
26	Dx-Coil Module	-	E03213		1		
26	Dx-Coil Module	-	E03214			1	
27	Remote Control	70510002	E04714	1	1	1	PC-ARFPE (Optional)
28	PCB Assy	-	E04323	1	1	1	
29	HEX Service Cover	-	E04032	1			
29	HEX Service Cover	-	E04033		1	1	

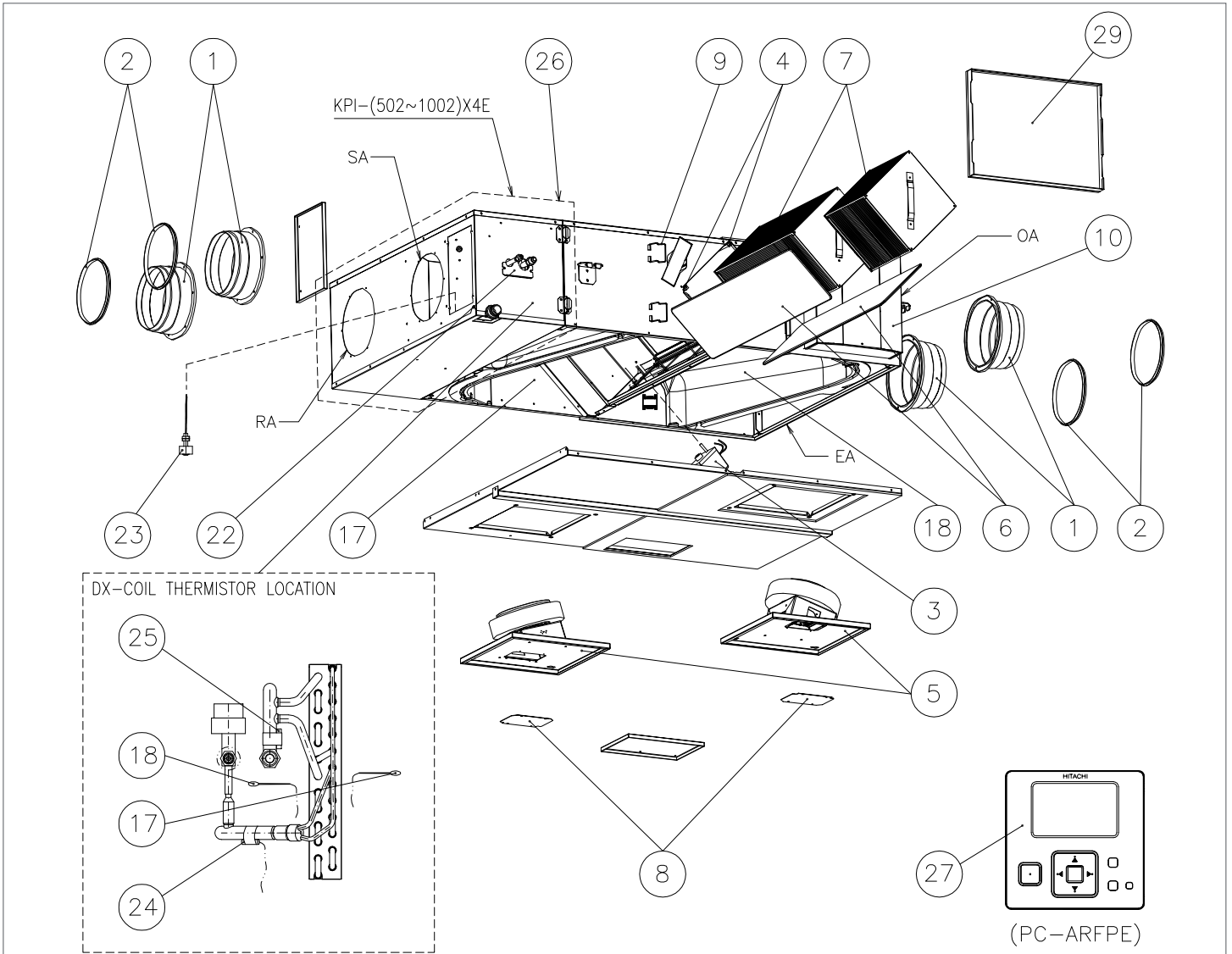

LOCATION OF ELECTRICAL EQUIPMENT IN THE ELECTRICAL BO

KPI-(252~2002)(E/X)4E

