

PRODUCT CODE	
60297331	
60297339	

MODEL NAME	
P-GP160NAP	
P-GP160KAP	

No.	DESCRIPTION	DWG No.	PART No.	Qty	Qty	REMARKS
1	Guide	A10315110A	-	4	4	
2	Louver Assy	A10315170A	P32433	4	4	Assembly (No. 2-1 Bearing x 1, No.2-2 Stopper x 1 Included)
2-1	Bearing	A10315200A	P32434	4	4	
2-2	Stopper	17F13549A	-	4	4	
3	Bearing	A10315200A	P32434	4	4	
4	AS Motor Assy	17H23268A	P30088	4	4	
5	CP-Cover Assy	A10315470A	P32435	3		
5	CP-Cover Assy	A10315470B	P32732		3	
6	CP-Cover Assy	A10315470D	P32436	1		HITACHI Label
6	CP-Cover Assy	A10315470E	P32733		1	HITACHI Label
7	Grille Assy	A10315580D	P32730	1		
7	Grille Assy	A10315580E	P32731		1	
7-1	Air Inlet Grille	A10315590A	P32438	1		
7-1	Air Inlet Grille	A10315590B	P32735		1	
7-2	Knob	A10315720A	P32439	2	2	
7-3	Knob Holder	A10315730A	P32440	2	2	
7-4	Spring	17G53242A	P24454	2	2	
7-5	Air Filter	17B31467B	P31977	1	1	
8	CP-Cover Assy S	A10315800A	P32441	2	2	
9	CP-Cover Assy M	A10586270A	P32442	1	1	
10	CP-Cover Assy L	A10315870A	P32443	1	1	
11	Oil Guard	A10316250A	P32444	1	1	
12	Screw Holder	A10316920A	-	4	4	
13	Long Screw	17G10414A	P21335	4	4	M6X50
14	Decorative Grille	A10315760A	P32445	2		
14	Decorative Grille	A10315760B	P32734		2	
15	Cable AS	17B47588A	-	1	1	for Motor of Louver
16	Insulation	17H32641E	-	2	2	
17	Insulation	17H32641F	-	2	2	
18	Insulation	17H32641B	-	4	4	

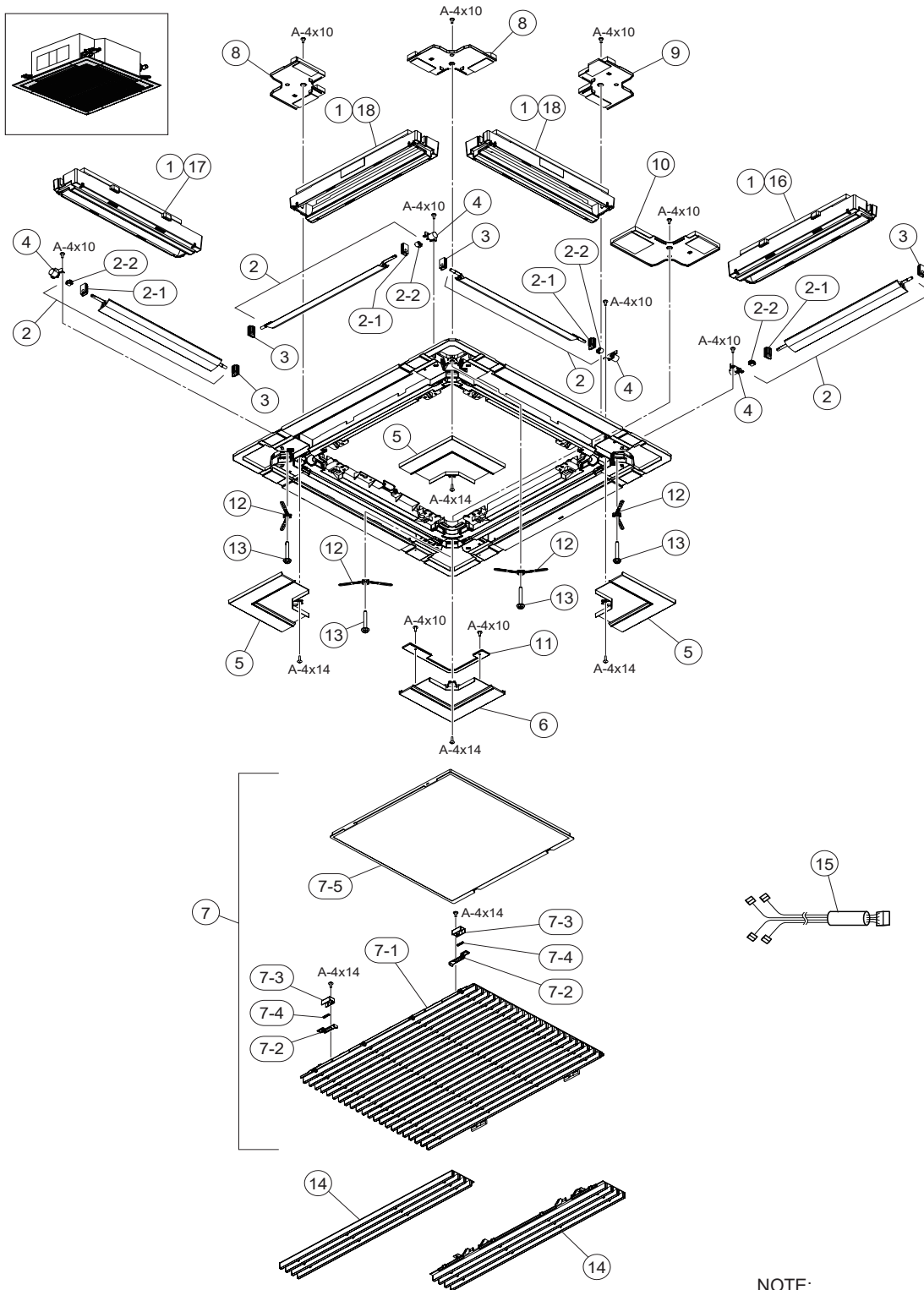

A	Truss Head Tapping Screw		F	Stud Bolt	
B	Round Head Screw		G	Nut	
C	Flat Head Screw		H	Washer	
D	Pan Head Tapping Screw		J	Spring Lock Washer	
E	Hexagon Head Bolt		K	Toothed Lock Washer	

NOTE:  
The unicomated coating is applied to iron and steel material for the unspecified materials of the bolt and screw.

**NOTE:**

The parts without order number are the custom-ordered, and these are not mentioned in the price list. When ordering them, the part name and the drawing number are required. Contact your HITACHI distributor for the delivery date and price about them.